

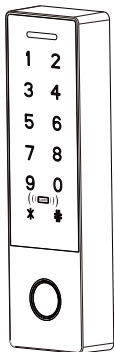

S4A Industrial Co., Limited

# Fingerprint Access Control System User Manual



## I. Product Overview and Installation Instruction

### Applicable Models

Status light

Keypad

Card-reading area

Fingerprint-reading area

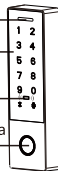

Fixing hole



S.N.	Functions
1	192 * 192 Capacitive fingerprint sensor
2	Built-in card reader
3	Fingerprint/ Card/ PIN access mode
4	Digital touch keypad
5	Wiegand output

- Operating Environment is as follows.
- Room temperature: -20°C ~ +50°C
- Relative humidity: 95%
- Operating Voltage & Current as follows.
- Input DC: +12V
- Standby current:  $\leq 60\text{mA}$
- Operating current:  $\leq 120\text{mA}$

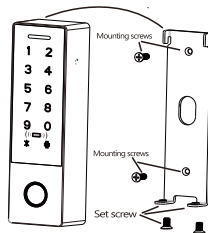

☺ Due to continuous update of our products

## II. Inputting Fingerprint

Suggested finger: index finger, middle finger or ring finger instead of thumb or little finger

### 1) Correct method

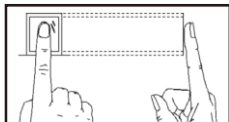

Use the finger to evenly press the center of fingerprint area

### 2) Wrong methods

Incomplete touch

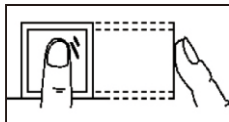

Off center

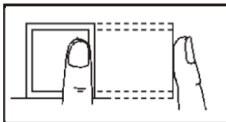

Turn sideways

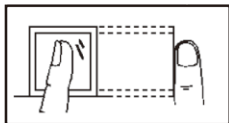

Low position

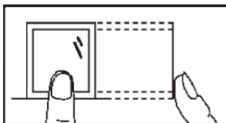

Please input fingerprint correctly for verification, and improper operation might result in poor performance of this device

## III. Connection power supply and lock

### 1. using special access control power supply wiring diagram

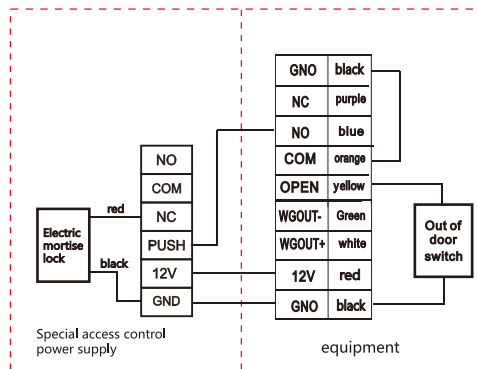

## IV. Administrator Operation

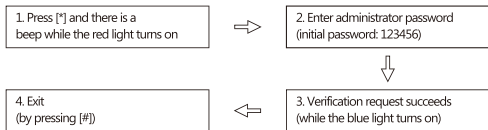

### Remarks:

After successful verification, user is allowed to register Administrator account. Then the initial password will be invalid.

### 4.1 Registering Administrator

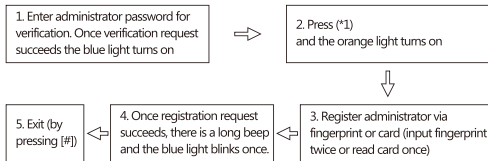

### Remarks:

1. It is allowed to register with 5 administrator only via fingerprint or card.

### 4.2 If the administrator password is lost.

Power off, press the exit button, hold it and power on, there will be a long beep, release the button, means delete Administrators successfully

**Attention:** Do not release the # button until one long beep

## V. To enroll a new user

### 5.1 A new users ID will be generated automatically.

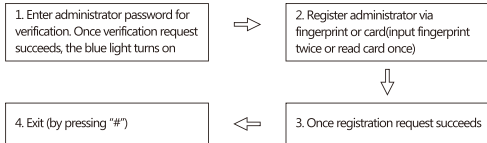

### 5.2 Register users by inputting the Employee ID directly

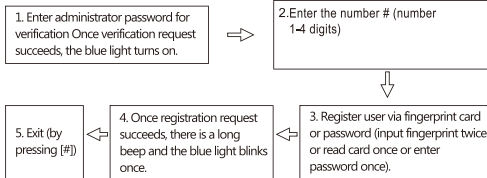

**Note: the password is 6 bits**

## VI: Verification

### 6.1 User Verification via Fingerprint or Card

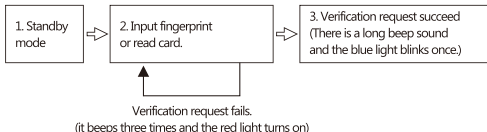

## 6.2 User Verification via Password

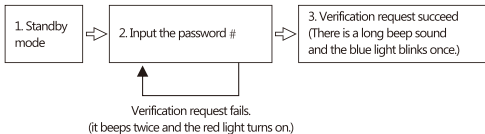

## VII: Deleting Users

### 7.1 Delete a User

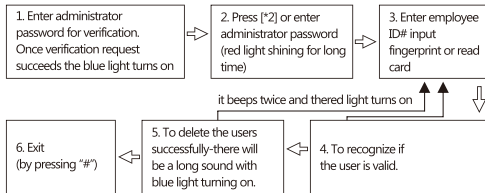

### 7.2 Delete All Users

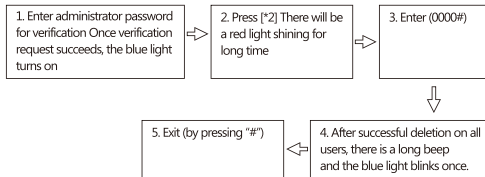

## VIII: Access Control System Management

### 8.1 System Settings

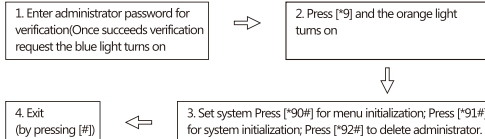

### 8.2 Setup the time for unlocking.

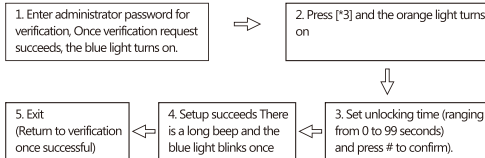

## IX: Unpacking

Description	Specifications	Quantity	Remarks
Device		1	
Packaging box		1	
Plastic plugs	Φ 4mmX28mm	2	For mounting and fixing
Self-tapping screws	Φ 4mmX28mm	2	For mounting and fixing